



ASKING PRICE

£149,950

Friars Rise

Whitley Bay, NE25 9BA

Fresh Property Centre welcome to the market this delightful first floor apartment on Friars Rise, Whitley Bay. The property offers a perfect blend of modern living and comfort.

The apartment features a lounge with a Juliet balcony that invites natural light and fresh air into the space. This area is perfect for relaxing or entertaining guests. The well-appointed kitchen diner is designed for both functionality and style, making it an ideal spot for enjoying meals with family and friends.

The apartment boasts two generously sized bedrooms, providing comfortable accommodation for residents. The bathroom is conveniently located, ensuring ease of access for all.

Residents will appreciate the added benefit of dedicated parking, making it easy to come and go as you please. With vacant possession, this property is ready for you to move in and make it your own.

2



1



1





First Floor

Approx. 61.4 sq. metres (661.4 sq. feet)

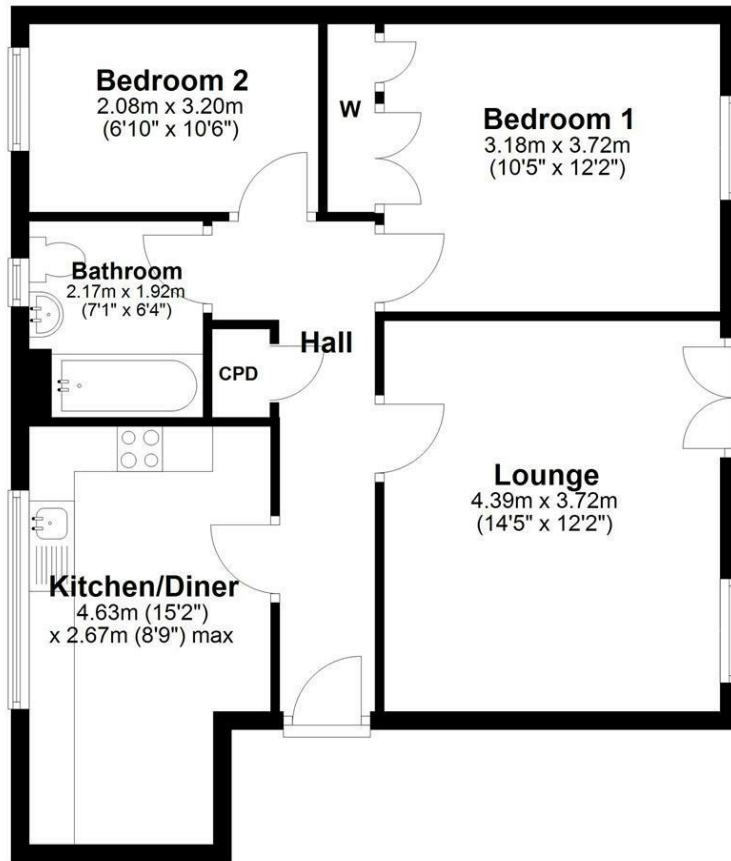

Total area: approx. 61.4 sq. metres (661.4 sq. feet)

LOCAL AUTHORITY

North Tyneside

TENURE

Leasehold

COUNCIL TAX BAND

B

VIEWINGS

By prior appointment only

Energy Efficiency Rating		
	Current	Potential
Very energy efficient - lower running costs		
(92 plus) A		
(81-91) B	79	79
(69-80) C		
(55-68) D		
(39-54) E		
(21-38) F		
(1-20) G		
Not energy efficient - higher running costs		
England & Wales	EU Directive 2002/91/EC	

Agents Note: Whilst every care has been taken to prepare these particulars, they are for guidance purposes only. All measurements are approximate and are for general guidance purposes only and whilst every care has been taken to ensure their accuracy, they should not be relied upon and potential buyers/tenants are advised to recheck the measurements



OFFICE ADDRESS

63 Church Way
North Shields
Tyne & Wear
NE29 0AE

OFFICE DETAILS

0191 257 6823
hello@fresh.property
www.freshpropertycentre.co.uk